

CROWN LANE
DEREHAM NR19
POA

abbotFox Land and New Homes presents this development with planning permission granted for 5 detached residential dwellings on a plot extending to 1.2 acres stms.

Little Fransham is an attractive rural village in the Breckland District of Norfolk. The village offers a range of services and amenities, including butchers/deli and a public house, with the neighbouring village of Necton offering a village shop, post office and primary school all within two miles. The site is situated in a rural location but close to a number of larger towns including Swaffham and Dereham.

Call abbotFox Land and New Homes for further information

Breckland council planning reference: 3PL/2018/0996/O



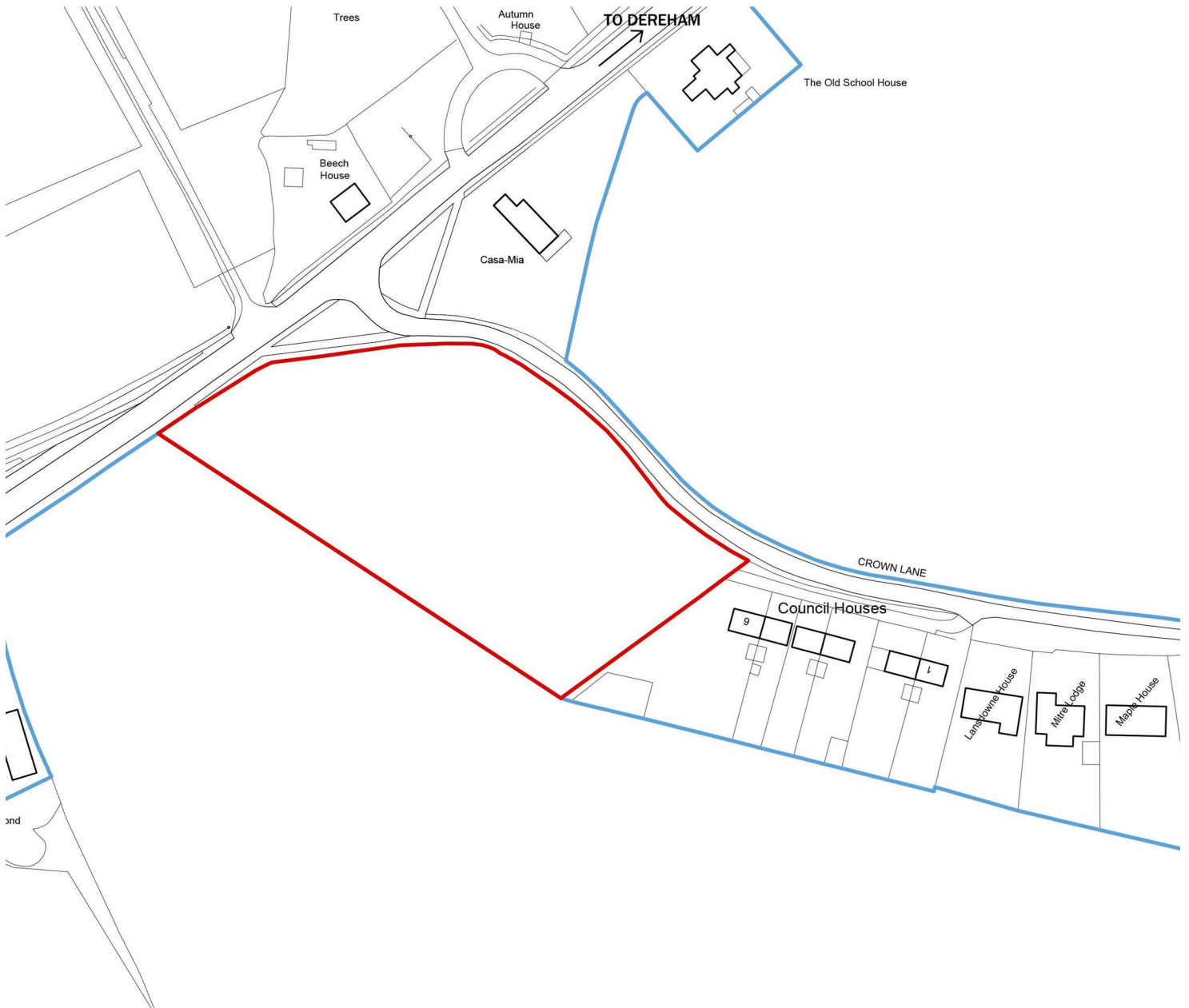

EPC

Energy Efficiency Rating	Current	Potential
Very energy efficient - lower running costs		
(92 plus) A		
(81-91) B		
(69-80) C		
(55-68) D		
(39-54) E		
(21-38) F		
(1-20) G		
Not energy efficient - higher running costs		
England & Wales	EU Directive 2002/91/EC	

Environmental Impact (CO ₂) Rating	Current	Potential
Very environmentally friendly - lower CO ₂ emissions		
(92 plus) A		
(81-91) B		
(69-80) C		
(55-68) D		
(39-54) E		
(21-38) F		
(1-20) G		
Not environmentally friendly - higher CO ₂ emissions		
England & Wales	EU Directive 2002/91/EC	

MAP



Disclaimer – In accordance with the Property Misdescriptions Act, the company gives notice that all descriptions, references to condition, necessary permissions for use and other details are given in good faith and believed to be correct, but any intending lessees do not rely on them as statements of fact, but must satisfy themselves by inspection or other means, as to their accuracy.